

Building Sketch (Page - 1)

Borrower/Client				
Property Address	3812 Valley View Ln			
City	Flower Mound	County	Denton	State TX Zip Code 75022
Lender	The Gaskill Group			

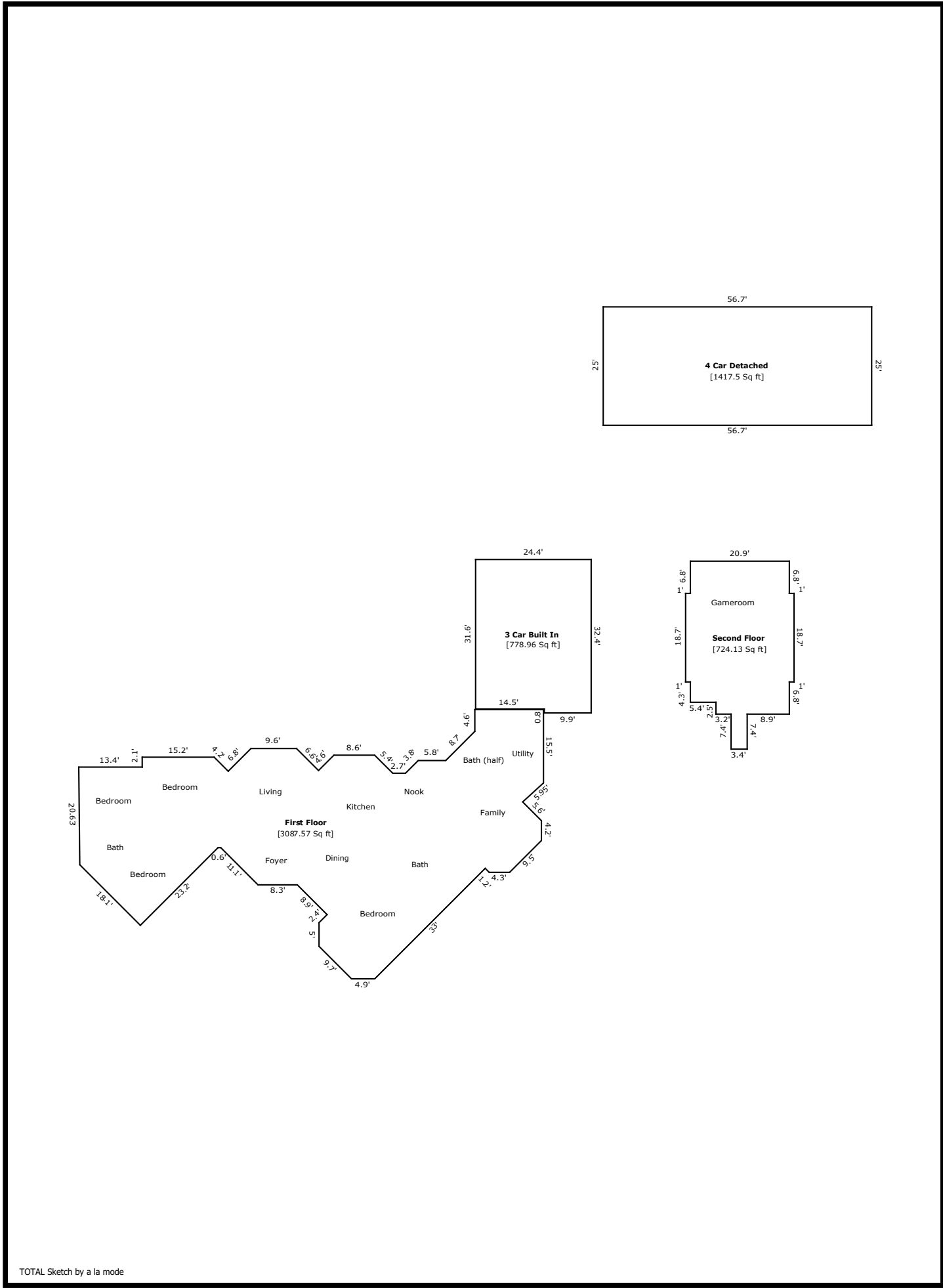

TOTAL Sketch by a la mode

Building Sketch (Page - 2)

Borrower/Client				
Property Address	3812 Valley View Ln			
City	Flower Mound	County	Denton	State TX Zip Code 75022
Lender	The Gaskill Group			

TOTAL Sketch by a la mode

Area Calculations Summary

Living Area	Calculation Details		
First Floor	3087.57 Sq ft		
		$0.5 \times 2.97 \times 2.97 =$	4.41
		$0.5 \times 2.97 \times 2.97 =$	4.41
		$9.5 \times 2.97 =$	28.21
		$0.5 \times 0.07 \times 0.07 =$	0
		$15.44 \times 0.07 =$	1.09
		$1.2 \times 15.51 =$	18.61
		$0.5 \times 3.46 \times 3.46 =$	6
		$48.51 \times 3.46 =$	168.08
		$0.86 \times 51.98 =$	44.93
		$0.5 \times 6.22 \times 0.28 =$	0.88
		$0.5 \times 8.84 \times 8.84 =$	39.03
		$8.84 \times 58.2 =$	514.21
		$0.5 \times 1.84 \times 1.84 =$	1.7
		$0.5 \times 1.84 \times 1.84 =$	1.7
		$1.84 \times 65.19 =$	120.06
		$0.5 \times 1.69 \times 1.69 =$	1.43
		$0.5 \times 1.69 \times 1.69 =$	1.43
		$63.65 \times 1.69 =$	107.8
		$0.5 \times 5.31 \times 5.31 =$	14.08
		$55.94 \times 5.31 =$	296.85
		$0.5 \times 3.59 \times 3.59 =$	6.46
		$37.14 \times 3.59 =$	133.46
		$0.5 \times 0.51 \times 0.51 =$	0.13
		$0.5 \times 0.51 \times 0.51 =$	0.13
		$36.63 \times 0.51 =$	18.6
		$0.5 \times 1.91 \times 1.91 =$	1.82
		$0.5 \times 1.91 \times 1.91 =$	1.82
		$31.43 \times 1.91 =$	60.01
		$0.5 \times 3.45 \times 3.45 =$	5.96
		$33.34 \times 3.45 =$	115.09
		$36.79 \times 1.95 =$	71.67
		$0.5 \times 6.08 \times 6.08 =$	18.49
		$30.71 \times 6.08 =$	186.76
		$3.07 \times 26.11 =$	80.18
		$0.5 \times 0.42 \times 0.42 =$	0.09
		$26.11 \times 0.42 =$	11.08
		$49.74 \times 3.1 =$	154.42
		$0.5 \times 6.79 \times 6.79 =$	23.04
		$42.95 \times 6.79 =$	291.53
		$36.15 \times 4.2 =$	151.82
		$0.5 \times 4.01 \times 4.01 =$	8.03
		$32.14 \times 4.01 =$	128.78
		$0.5 \times 5.26 \times 5.26 =$	13.81
		$0.5 \times 5.26 \times 5.15 =$	13.54
		$21.73 \times 5.26 =$	114.23
		$0.5 \times 18.76 \times 9.48 =$	88.89
		$0.5 \times 2.97 \times 1.48 =$	2.2
		$0.5 \times 6.51 \times 3.25 =$	10.58
Second Floor	724.13 Sq ft		
		$18.7 \times 1 =$	18.7
		$18.7 \times 1 =$	18.7
		$3.4 \times 7.4 =$	25.16
		$20.9 \times 29.8 =$	622.82
		$2.5 \times 15.5 =$	38.75
Total Living Area (Rounded):	3812 Sq ft		
Non-living Area			
3 Car Built In	778.96 Sq ft		
		$9.9 \times 0.8 =$	7.92
		$24.4 \times 31.6 =$	771.04
4 Car Detached	1417.5 Sq ft		
		$25 \times 56.7 =$	1417.5