

**LOT 28
REGISTERED PLAN 423
CITY OF OTTAWA**

Surveyed by Annis, O'Sullivan, Vollebek Ltd.

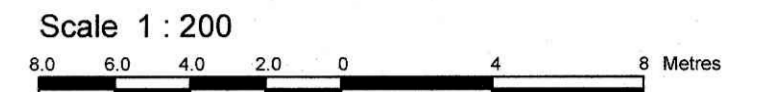

Metric
DISTANCES SHOWN ON THIS PLAN ARE IN METRES AND CAN BE CONVERTED TO FEET BY DIVIDING BY 0.3048

Surveyor's Certificate

I CERTIFY THAT:
1. This survey and plan are correct and in accordance with the Surveys Act and the Surveyors Act and the regulations made under them.
2. The survey was completed on the 22nd day of June, 2023.

Date: July 12, 2023
T. Hartwick
Ontario Land Surveyor

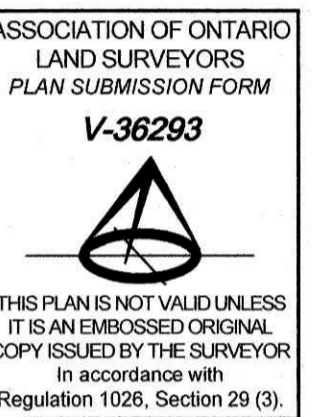

Notes & Legend

—□—	Denotes	Survey Monument Planted
—■—	"	Survey Monument Found
SIB	"	Standard Iron Bar
SSIB	"	Short Standard Iron Bar
IB	"	Iron Bar
IB#	"	Round Iron Bar
(WIT)	"	Witness
Meas.	"	Measured
(AOG)	"	Annis, O'Sullivan, Vollebek Ltd.
(PI)	"	Registered Plan 423
(P2)	"	Plan 5R-14046
(P3)	"	(AOG) Plan dated October 9, 1992
(P4)	"	(AOG) Plan dated May 29, 2018
C/L	"	Centreline
RWS	"	Retaining Wall - Stone
RWC	"	Retaining Wall - Concrete
RWT	"	Retaining Wall - Timber
—OW—	"	Overhead Wires
OP	"	Utility Pole
AN	"	Anchor
GM	"	Gas Meter
AC	"	Air Conditioner
○	"	Deciduous Tree
★	"	Coniferous Tree
∅	"	Diameter
∅ 65.00	"	Location of Elevations
∅ 65.00	"	Location of Elevations

Bearings are grid, derived from Can-Net 2016 Real Time Network GPS observations and are referenced to Specified Control Points 01919670852 and 01919791054, MTM Zone 9 (76°30' West Longitude) NAD-83 (original).

ELEVATION NOTES

1. Elevations shown are geodetic, derived from Vertical Control Monument No. 0011968U015, and are referred to the CGVD28 geodetic datum.
2. It is the responsibility of the user of this information to verify that the job benchmark has not been altered or disturbed and that its relative elevation and description agrees with the information shown on this drawing.

UTILITY NOTES

1. This drawing cannot be accepted as acknowledging all of the utilities and it will be the responsibility of the user to contact the respective utility authorities for confirmation.
2. Only visible surface utilities were located.
3. A field location of underground plant by the pertinent utility authority is mandatory before any work involving breaking ground, probing, excavating etc.

SITE AREA = 1125± Sq. m.

