

2300 East 55th Street, Blue Hills, Kansas City, Jackson County, Missouri, United States, 64130

Total area: 1083 sq. ft
Gross living area: 1083 sq. ft

Finished area: 1083 sq. ft
Non-standard finished area: 0 sq. ft

Level 1

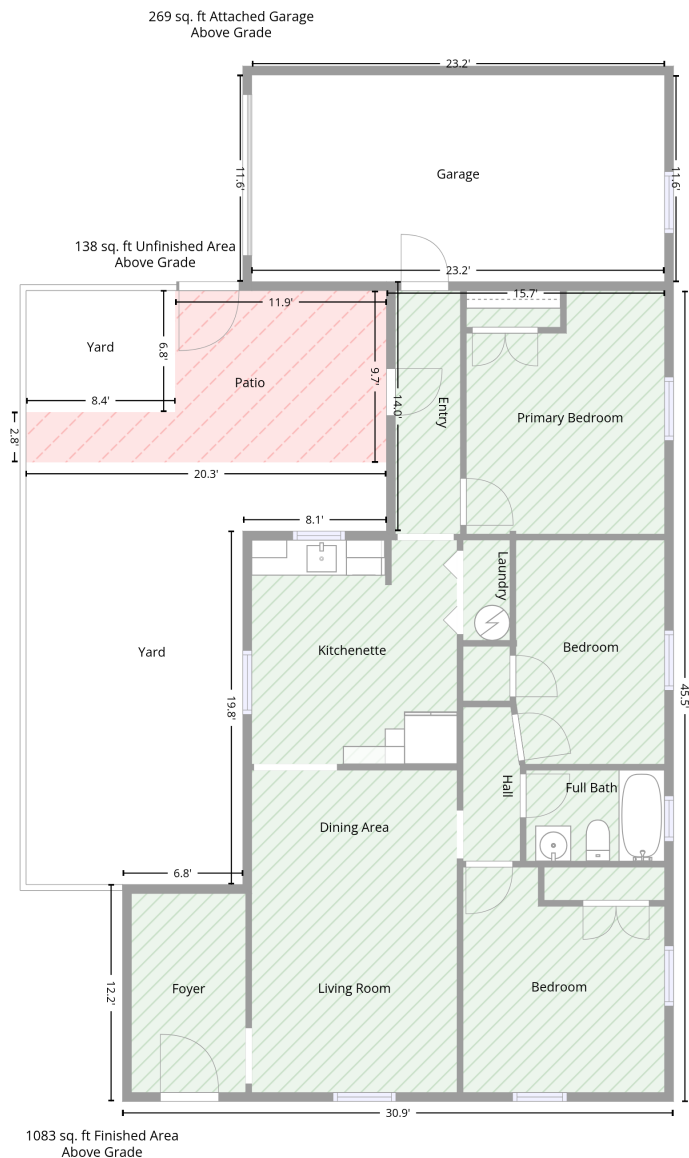

Total area: 1083 sq. ft
Gross living area: 1083 sq. ft

Finished area: 1083 sq. ft
Non-standard finished area: 0 sq. ft

2300 East 55th Street, Blue Hills, Kansas City, Jackson County, Missouri, United States, 64130

Total area: 1083 sq. ft
Gross living area: 1083 sq. ft

Finished area: 1083 sq. ft
Non-standard finished area: 0 sq. ft

Level 1

| Space | Area (sq. ft) | Calculation <small>Coordinate Polygon Area Algorithm using inches</small> |
|---|---------------|---|
| Finished Area <ul style="list-style-type: none">• Living area• Finished Area | 1083 | $-\left((403 + 403) * (191.4 - 197.4) + (403 + 409) * (197.4 - 197.4) + (409 + 409) * (197.4 - 743.9) + (409 + 37.5) * (743.9 - 743.9) + (37.5 + 37.5) * (743.9 - 597.7) + (37.5 + 118.6) * (597.7 - 597.7) + (118.6 + 118.6) * (597.7 - 359.5) + (118.6 + 215.4) * (359.5 - 359.5) + (215.4 + 215.4) * (359.5 - 191.4) + (215.4 + 403) * (191.4 - 191.4)\right) * 0.5 * 0.00694$ |
| PATIO <ul style="list-style-type: none">• Non-living area• Unfinished Area | 138 | $-\left((215.4 + 215.4) * (197.4 - 313.2) + (215.4 + -27.6) * (313.2 - 313.2) + (-27.6 + -27.6) * (313.2 - 279.3) + (-27.6 + 72.9) * (279.3 - 279.3) + (72.9 + 72.9) * (279.3 - 197.4) + (72.9 + 215.4) * (197.4 - 197.4)\right) * 0.5 * 0.00694$ |
| GARAGE <ul style="list-style-type: none">• Attached Garage | 269 | $-\left((403 + 403) * (52.2 - 191.4) + (403 + 124.6) * (191.4 - 191.4) + (124.6 + 124.6) * (191.4 - 52.2) + (124.6 + 403) * (52.2 - 52.2)\right) * 0.5 * 0.00694$ |

2300 East 55th Street, Blue Hills, Kansas City, Jackson County, Missouri, United States, 64130

Total area: 1083 sq. ft
Gross living area: 1083 sq. ft

Finished area: 1083 sq. ft
Non-standard finished area: 0 sq. ft

Property UPD

| Data | Value |
|----------------------------|-------|
| Structure | 1 |
| Unit | 1 |
| Level Number | 1 |
| Below Grade | false |
| Level Low Ceiling | false |
| ADU Indicator | false |
| Total Area | 1083 |
| Finished Area | 1083 |
| Non-Standard Finished Area | 0 |